

**FOR  
LEASE**

## **49 BRATTLE STREET**

Harvard Square | Cambridge, MA

±1,090 SF street-level with full basement



**TACTICAL  
REALTY  
GROUP**



---

## HARVARD SQUARE: A WORLD-CLASS DESTINATION

Harvard Square is a cultural and academic focal point of Greater Boston. Anchored by the world-renowned Harvard University, this market has an international draw. The retail offerings run the spectrum from designer fashion to trendy, casual streetwear and the culinary offerings are equally as diverse. Harvard Square balances national and international retailers with local small shop operators.

### QUICK STATS:



22,000 Harvard students



Harvard Square Station:  
23,199 average daily riders

### Within a one-mile radius:

**33.8** average age



Population: 55,846 people



Households: 22,878



Median income : \$84,842



Median home value: \$775,781





FIRST REPUBLIC  
It's a privilege to serve you®  
FJALL RAVEN  
Aēsop

49 BRATTLE STREET

Santander  
Bank of America  
CVS  
ORIGINS  
OTTO

RUSSELL HOUSE TAVERN  
Tasty Burger  
Capital One  
Starbucks  
PAPYRUS  
CVS

ANTHROPOLOGIE  
ANN TAYLOR

URBAN OUTFITTERS  
SWEET

THE BRATTLE THEATRE  
ALDEN & HARLOW

HARVARD SQUARE



CHIPOTLE MEXICAN GRILL  
GNC LIVE WELL.  
Eastern Bank

HARVARD HOTEL SQUARE  
73 keys

Peet's Coffee & Tea™

swēetgreen  
DAVIDsTEA  
WARBY PARKER

STAPLES  
SHAKE SHACK

CHARLES RIVER

# GROUND FLOOR

1,090 square feet

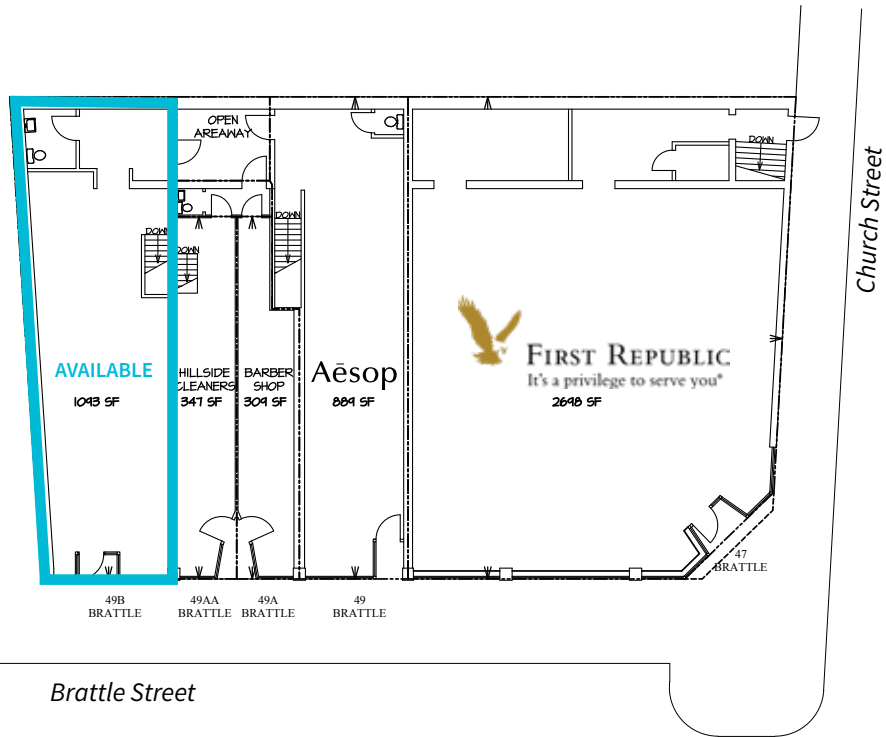

# BASEMENT

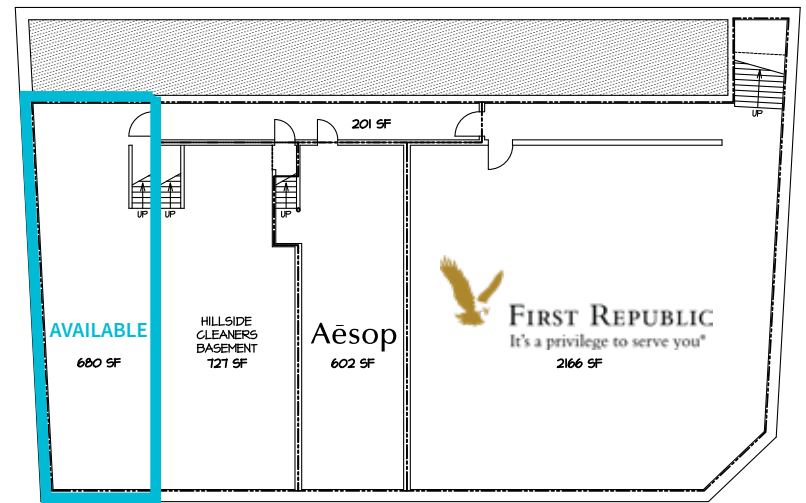



**TACTICAL  
REALTY  
GROUP**

**EXCLUSIVELY LISTED BY**

**SAM HAWKEY**

*Partner*

617.388.6642

Sam@TactBoston.com

**DANIEL BLOOM**

*Partner*

617.852.8123

Dan@TactBoston.com