



FOR LEASE

599 Massachusetts Avenue
Central Square / Cambridge, MA

±2,670 SF of street-level retail space available



TACTICAL
REALTY
GROUP



OVERVIEW

PAGE 3

MAP & RETAILERS

PAGE 4

FLOOR PLANS

PAGE 5

PRINTABLE BROCHURE

[LINK]

EXCLUSIVELY LISTED BY

SAM HAWKEY

Partner

617.388.6642

Sam@TactBoston.com

DANIEL BLOOM

Partner

617.852.8123

Dan@TactBoston.com

OVERVIEW

599 Massachusetts Avenue is situated in the heart of Cambridge's Central Square. This trade area has become a hot spot point for students, residents, and local office populations alike. In Central's immediate vicinity there is over seven million square feet of office space and 11 million square feet of Biotech Lab space in Kendall Square. In addition to the only metro Boston H Mart supermarket, Central Square has restaurants concepts by two James Beard winning chefs (Cragie on Main and Little Donkey) and is situated within walking distance to Harvard University (26,000 person campus) and MIT (12,500 person campus).



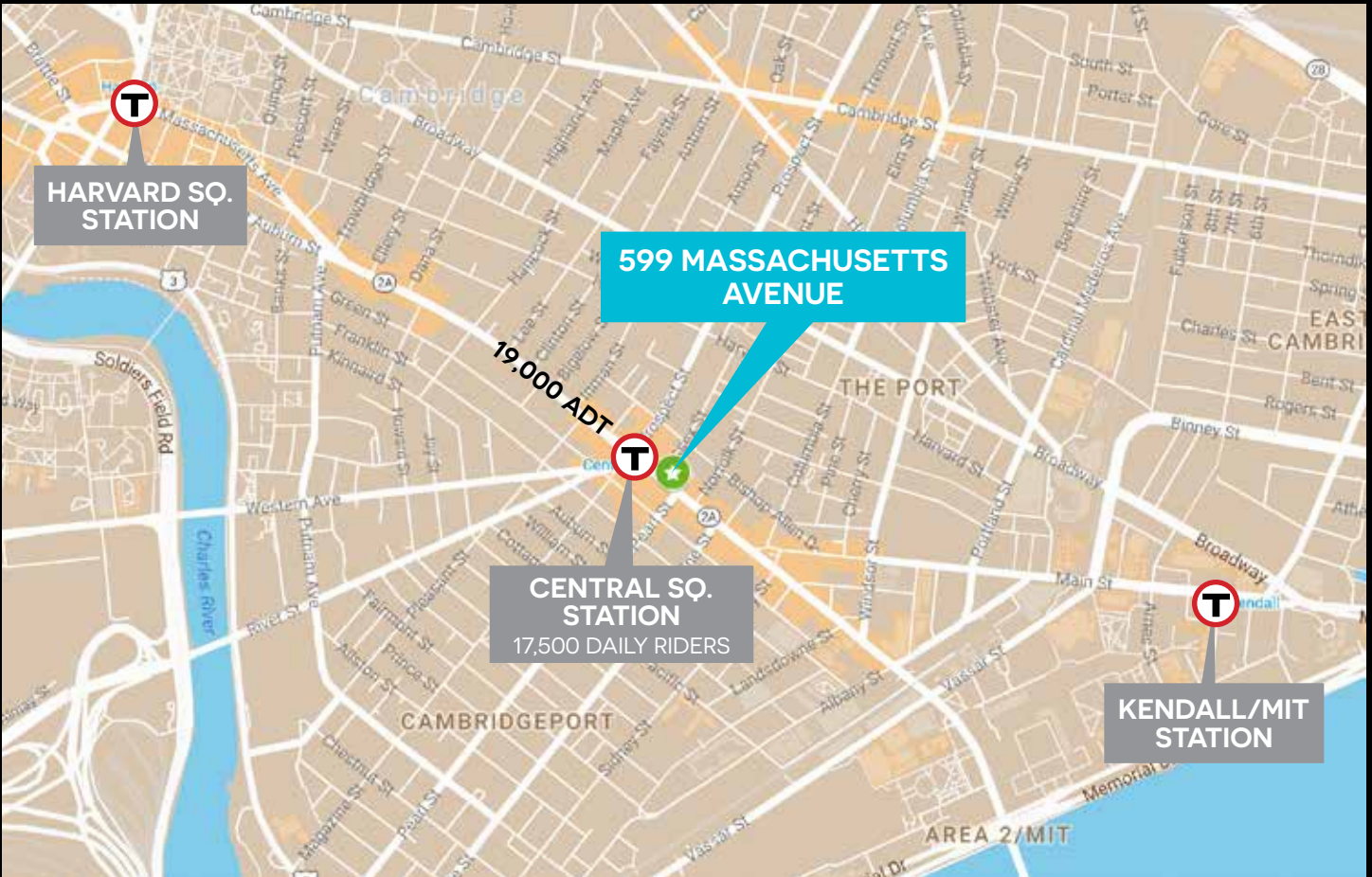

SURROUNDING RETAILERS



FLOOR PLANS

First Floor

+/- 2,670 square feet

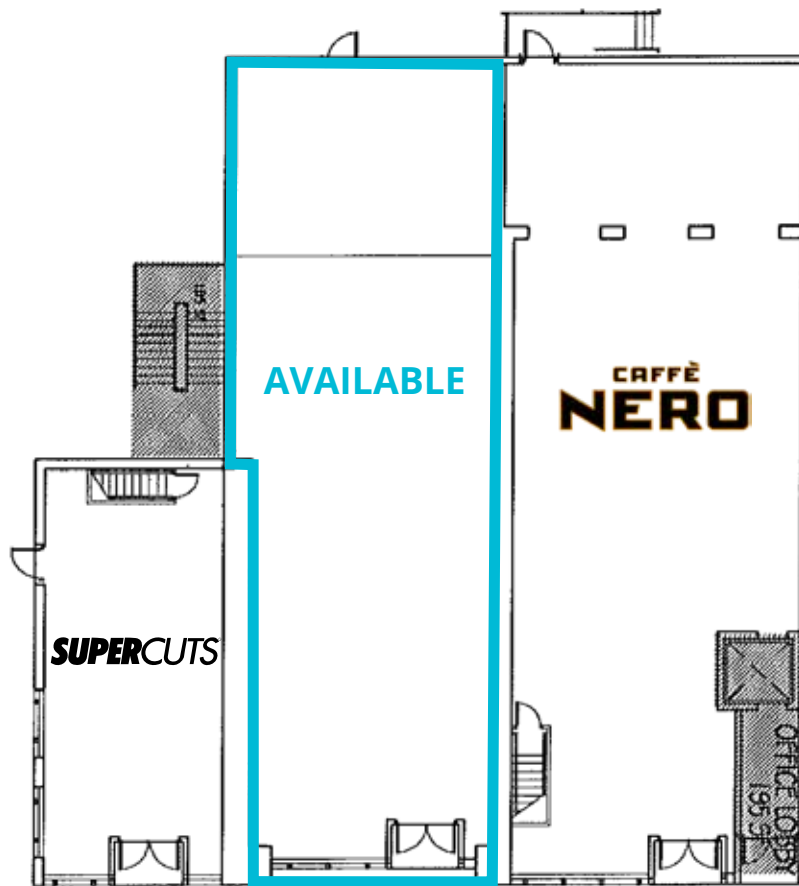

Second Floor

+/- 2,400 square feet

(If additional space is needed)

